

## Standard Screw Head Types



**Flat/ Countersunk Head**

A countersunk head with a flat top.



**Oval head**

A countersunk head with a oval top.



**Pan Head**

A slightly rounded head with short vertical sides



**Truss Head**

An extra wide head with a rounded top.



**Round Head**

A domed head

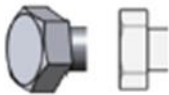

**Hex Head**

A hexagonal head



**Hex Washer Head**

A hex head with built in washer.



**Slotted Hex Washer Head**

A hex head with built in washer and a slot.



**Socket Cap Screw**

A small cylindrical head using a socket drive.



**Button Screw**

A low-profile rounded head using a socket drive.